

# Compact Range

New range of Pilot Devices, 22 mm



# Pilot Devices, Compact Range

## The competitive choice

The compact range is a new competitive choice for OEM customers and Panel Builders with high requirements of cost efficient, easy to use and reliable products.

### Features

- Reliable performance
- Less stock-keeping
- "All-in-one function" One Order Code = one complete function
- Robust design
- Easy mounting

### Part of the ABB Family

The compact range can easily be combined with our modular Pilot Devices as they have the same front design.

### Worldwide availability

ABB is represented in over 130 countries. Our pilot devices meet all major international and national standards.

### Technical advantages

- High degree of protection
- One or two built-in electrically separated contacts (1NO, 1NC, 2NO, 2NC or 1NC + 1NO)
- Contacts with wiping action
- Low built-in depth



Same front design for both the modular and the compact range. Robust actuators in clear colors with large text and push area.



Samples of accessories



42mm

## Pushbuttons, non-illuminated



Contacts included		Pushbutton		Pushbutton		Pushbutton		Pushbutton	
NO	NC	Momentary Flush button	List Price	Maintained Flush button	List Price	Momentary Extended button	List Price	Maintained Extended button	List Price
1	-	CP110-10	15.20	CP210-10	19.90	CP310-10	15.20	CP410-10	19.90
2	-	CP110-20	19.90	CP210-20	22.50	CP310-20	19.90	CP410-201	22.50
-	1	CP110-01	15.20	CP210-01	19.90	CP310-01	15.20	CP410-01	19.90
-	2	CP110-02	19.90	CP210-02	22.50	CP310-02	19.90	CP410-02	22.50
1	1	CP110-11	19.90	CP210-11	22.50	CP310-11	19.90	CP410-11	22.50

Color	Code letter
Red	R
Green	G
Yellow	Y
Blue	L
White	W
Black	B
Grey	U

### Ordering example

Requested: A compact pushbutton, momentary, with red extended button and one NO contact.

Order: 1 piece of CP310R-10



## Pushbuttons, non-illuminated



Contacts included		Pushbutton		Pushbutton	
NO	NC	Momentary Flush button, white	List Price	Maintained Extended button, black with white 0	List Price
1	-	with black I	CP1110W-10	16.70	-
-	1	with black II	CP1210W-10	16.70	CP3310B-01
-	-	-	-	-	21.40

Discount Schedule CA

# Selector switches, non-illuminated



## Two position

Contacts included  
NO NC  
| |  
| |

Maintained      Maintained      Momentary

		Catalog No.	List Price	Catalog No.	List Price	Catalog No.	List Price
1	-	C2SS110-10	19.60	C2SS210-10	19.60	C2SS310-10	22.70
2	-	C2SS110-20	27.20	C2SS210-20	27.20	C2SS310-20	27.20
-	1	C2SS110-01	22.70	C2SS210-01	22.70	C2SS310-01	22.70
-	2	C2SS110-02	27.20	C2SS210-02	27.20	C2SS310-02	27.20
1	1	C2SS110-11	27.20	C2SS210-11	27.20	C2SS310-11	27.20

## Three position

Contacts included  
NO NC  
| |  
| |

Maintained      Momentary      Momentary      Momentary

		Catalog No.	List Price	Catalog No.	List Price	Catalog No.	List Price	Catalog No.	List Price
2	-	C3SS110-20	27.20	C3SS210-20	27.20	C3SS310-20	27.20	C3SS710-20	27.20
-	2	C3SS110-02	27.20	C3SS210-02	27.20	C3SS310-02	27.20	C3SS710-02	27.20
1	1	C3SS110-11	27.20	C3SS210-11	27.20	C3SS310-11	27.20	C3SS710	

### Ordering example

Requested: A red compact selector switch with three positions, Momentary, spring return from A to B and maintained position in C. With 2 NC contacts.

**Order: 1 piece of C3SS710R-02**



## Accessories

Description Order Code List Price

### Protective membrane

Of transparent, heat and cold resistant rubber.  
Does not harden at low temperature. Gives IP 67 degrees of protection. When membrane is used, remove the gasket.

For operator with:

Flush button	<b>CBK-KXB</b>	8.00
Extended button	<b>CBK-KXBE</b>	8.00

### Mounting tool

Used for tightening the nut of the attachment device.	<b>CBK-KXHT</b>	10.00
---	-----------------	-------

### 30 mm adaptors

For use when fitting the 22 mm pilot devices in 30 mm mounting holes. (1.5 – 4 mm panels)

#### For use with 22 mm Compact Pilot Light

Black plastic	<b>CBK-K3A</b>	8.00
Metal	<b>CBK-M3A</b>	10.00

Description Type Order Code Weight, kg

### Lamp changing tool

Designed for two different lamp diameters. The larger diameter fits filament bulbs and LEDs and the smaller diameter fits neon bulbs.

	<b>KA1-8072</b>	10.00
--	-----------------	-------

Description Order Code Weight, kg

### Legend plates

#### Engraved fixed plates with symbol/text

Symbol/text Legend plate material

#### For pushbutton

O	Silver-grey aluminium	<b>CBK-NPE</b>	1.50
Off	Silver-grey aluminium	<b>CBK-NPE10</b>	1.50
On	Silver-grey aluminium	<b>CBK-NPE11</b>	1.50
Start	Silver-grey aluminium	<b>CBK-NPE19</b>	1.50
Stop	Silver-grey aluminium	<b>CBK-NPE20</b>	1.50

Symbol/text

Centre Right Legend plate material

#### For two-position selector switch

O	I	Silver-grey aluminium	<b>CBK-NPE</b>	1.50
Hand	Auto	Silver-grey aluminium	<b>CBK-NPE22</b>	1.50
Off	On	Silver-grey aluminium	<b>CBK-NPE24</b>	1.50
Stop	Start	Silver-grey aluminium	<b>CBK-NPE25</b>	1.50

Symbol/text

Left Centre Right Legend plate material

#### For three-position selector switch

I	O	II	Silver-grey aluminium	<b>CBK-NPE</b>	1.50
Hand	O	Auto	Silver-grey aluminium	<b>CBK-NPE26</b>	1.50
Slow	Off	Fast	Silver-grey aluminium	<b>CBK-NPE27</b>	1.50

#### Discount Schedule CA

## Technical data

### Standards

IEC 73, 529, 947-5-1, 947-5-5  
EN 50 013, 60 947-5-1  
UL 508  
CSA C22.2 No. 14

### Degree of protection

<b>Operators</b>	ICC	UL/CSA
Compact pushbutton	IP 66	1, 12, 3R, 4, 4X
Compact pilot lights	IP 66	1, 12, 3R, 4, 4X
Compact selector switch	IP 66	1, 12, 3R, 4, 4X

### Electrical functions

Terminals	IP 20
-----------	-------

### Mechanical life

Pushbuttons	0.5 million operations
Selector switches	0.5 million operations

### Temperature

Ambient temperature during operation	-25 to +70 °C
Storage temperature	-30 to +85 °C

### Terminals

Plus-minus Pozidrive Size 2	min. 1 x 0.5 mm <sup>2</sup> max. 2 x 1.5 mm <sup>2</sup> 2 x AWG14
Connectable area	

### Contacts

#### Ratings as per UL, CSA, NEMA C300, R300

Rated insulation voltage	250 V
Rated thermal current	2.5 A
Rated operational current at 120 V	1.5 A
240 V	0.75 A

#### Ratings as per IEC 947-5-1

Rated insulation voltage, U <sub>i</sub>	300 V
Rated thermal current, I <sub>th</sub>	5 A
Rated operational current, I <sub>b</sub> , utilisation category AC 15, at 120 V	1.5 A
240 V	1 A

Rated operational current, I <sub>b</sub> , utilisation category DC 13, at 24 V	0.3 A
125 V	0.2 A

#### Short circuit protection

Max. fuse at 1 kA	16 A ordinary 10 A delayed
-------------------	-------------------------------

<b>Bulbs</b>	3 W, 240 V
--------------	------------

## Drilling plan

### for pushbuttons, switches and pilot lights

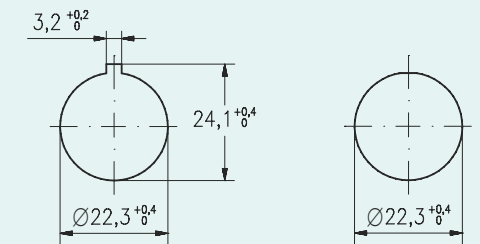

## Dimensions

### Compact Pushbutton

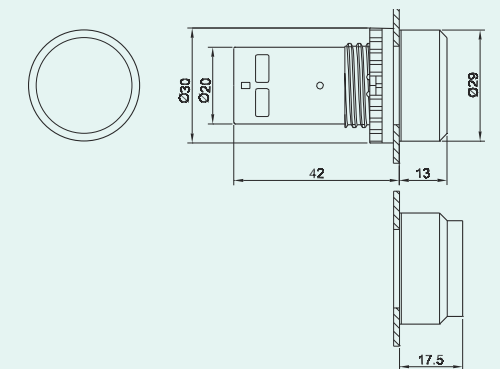

### Compact Selector Switch

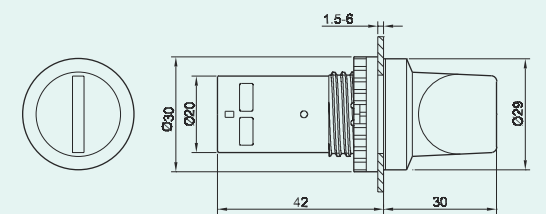

### Compact Pilot Light

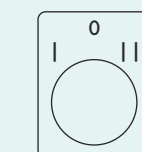
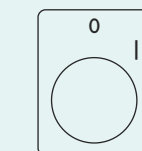
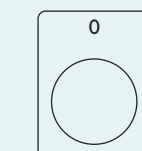
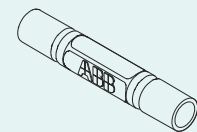
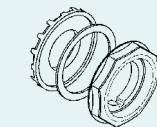
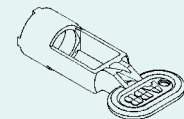
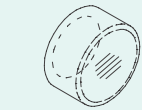
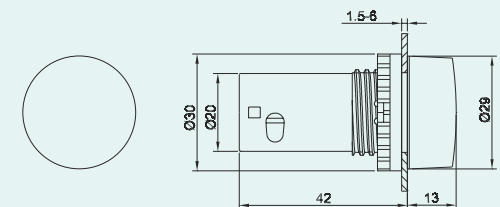

29.6 x 39 mm  
Text height 3 mm

# Get in touch with the Pilot Devices from ABB

*A pushbutton has to be sturdy and reliable,  
applicable in all environments and adaptable to  
widely differing requirements. Further, it should be  
easy to install.*

*You will find all these features in ABB's range of  
Pilot Devices.*



ABB Automation Technology Products AB/Control, SE-721 61 Västerås, Sweden, Telephone +46 21 32 07 00, Telefax +46 21 12 60 01  
1SFC 151001B0201, September, 2002 Prod. ABB Automation Technology Products AB/Control/XM Printed in Västerås, Sweden



**ABB Inc.**  
**Low Voltage Products & Systems**  
1206 Hatton Rd.  
Wichita Falls, TX 76302  
Tel: (888) 385-1221  
(940) 397-7000  
Fax: (940) 397-7085

[www.abb-control.com](http://www.abb-control.com)