

Key-operated selector switches^① 2 and 3 positions

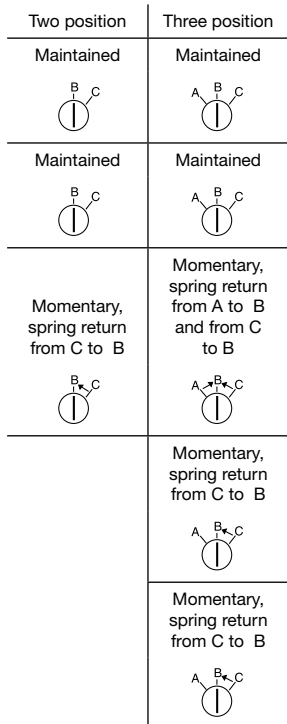

Δ Key code 1 Ronis 71
 2 Ronis 72
 3 Ronis 73

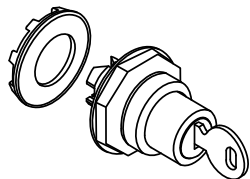
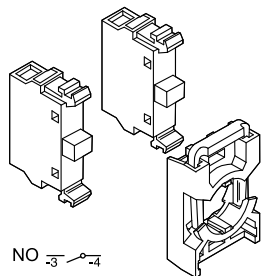

NO

NC

Description	The key can be removed in...	Catalog number	List price
2-position			
Black plastic bezel			
Maintained B & C	B & C	G1M2SSK1-10Δ	\$ 49.00
Maintained B & C	B only	G1M2SSK2-10Δ	49.00
Spring return C to B	B only	G1M2SSK3-10Δ	49.00
Chrome bezel			
Maintained B & C	B & C	G2M2SSK1-30Δ	51.00
Maintained B & C	B only	G2M2SSK2-30Δ	51.00
Spring return C to B	B only	G2M2SSK3-30Δ	51.00
3-position			
Black plastic bezel			
Maintained A, B, & C	A, B & C	G1M3SSK1-10Δ	61.00
Maintained A, B, & C	B only	G1M3SSK2-10Δ	61.00
Spring return A & C to B	B only	G1M3SSK3-10Δ	61.00
Spring return C to B	A only	G1M3SSK4-10Δ	61.00
Spring return C to B	A, B, & C	G1M3SSK5-10Δ	61.00
Chrome bezel			
Maintained A, B, & C	A, B & C	G2M3SSK1-30Δ	63.00
Maintained A, B, & C	B only	G2M3SSK2-30Δ	63.00
Spring return A & C to B	B only	G2M3SSK3-30Δ	63.00
Spring return C to B	A only	G2M3SSK4-30Δ	63.00
Spring return C to B	A, B, & C	G2M3SSK5-30Δ	63.00

Contact blocks and holder

Blocks	Catalog number	Ref. code	List price
2 NO with holder	MCBH-20	1SFA 611 605 R1102	\$ 18.00
2 NC with holder	MCBH-02	1SFA 611 605 R1120	
1 NO + 1 NC with holder	MCBH-11	1SFA 611 605 R1111	
1 NO without holder	MCB-10	1SFA 611 610 R1001	8.00
1 NC without holder	MCB-01	1SFA 611 610 R1010	8.00
Holder for 3 blocks	MCBH-00	1SFA 611 605 R1100	2.00

Contact functions

2 positions: See Page 9
3 positions: See Page 9

Ordering example

Requested: A key-operated selector switch. Three positions. Maintained. The key removeable in position B. Key code 72. With 2 NC contacts

Ref.: 1 piece of G1M3SSK2-402 + 1 piece of MCBH-02

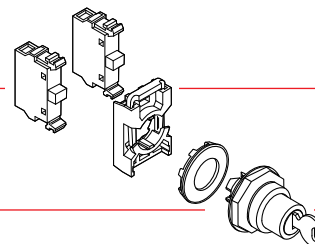

① Includes two keys