

Double pushbuttons Non-illuminated

Operator ...

Upper button		Lower button		Catalog No.	Ref. Code	List Price
Color	Text	Color	Text			
with flush buttons ①						
Green	No text	Red	No text	MPD1-11B	1SFA 611 130 R1106	\$ 18.00
	I	O	O	MPD2-11B	1SFA 611 131 R1106	21.00
	ON	OFF	OFF	MPD3-11B	1SFA 611 132 R1106	21.00
	START	STOP	STOP	MPD4-11B	1SFA 611 133 R1106	21.00
White	No text	Black	No text	MPD5-11B	1SFA 611 134 R1106	18.00
	I	O	O	MPD6-11B	1SFA 611 135 R1106	21.00
	ON	OFF	OFF	MPD7-11B	1SFA 611 136 R1106	21.00
	START	STOP	STOP	MPD8-11B	1SFA 611 137 R1106	21.00

with extended lower button ①

Green	No text	Red	No text	MPD12-11B	1SFA 611 141 R1106	18.00
	I	O	O	MPD13-11B	1SFA 611 142 R1106	21.00
	ON	OFF	OFF	MPD14-11B	1SFA 611 143 R1106	21.00
	START	STOP	STOP	MPD15-11B	1SFA 611 144 R1106	21.00
White	No text	Black	No text	MPD16-11B	1SFA 611 145 R1106	18.00
	I	O	O	MPD17-11B	1SFA 611 146 R1106	21.00
	ON	OFF	OFF	MPD18-11B	1SFA 611 147 R1106	21.00
	START	STOP	STOP	MPD19-11B	1SFA 611 148 R1106	21.00

Contact blocks, and holder

Blocks	Catalog No.	Ref. Code	List Price
2 NO with holder	MCBH-20	1SFA 611 605 R1102	\$ 18.00
2 NC with holder	MCBH-02	1SFA 611 605 R1120	
1 NO + 1 NC with holder	MCBH-11	1SFA 611 605 R1111	
1 NO without holder	MCB-10	1SFA 611 610 R1001	8.00
1 NC without holder	MCB-01	1SFA 611 610 R1010	8.00
Holder for 3 blocks	MCBH-00	1SFA 611 605 R1100	2.00

Ordering example – Double pushbutton

Requested: A non-illuminated double pushbutton, Green/Red,
No text, with 2 NO blocks

Ref.: 1 piece of MPD1-11B + 1 piece of MCBH-20

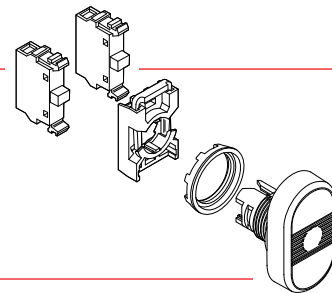

① No contact block in the center position.