

Assembled Stations & enclosures

ABB Assembled stations & enclosures



8

Features

- Available for 1, 2, 3, 4 & 6 operators.
- Base mounted contacts allow for easy removal of operator cover. Wiring remains with base.
- Up to 5 contact blocks can be used per operator for some combinations.
- Environmental ratings: UL/CSA Type 1, 3R, 4, 4X, 12 & 13, IP66
- Available in high impact strength polycarbonate (plastic) material.
- Rated for outdoor use.
- Enclosures can withstand light acid solutions and other chemicals.
- Metallic enclosures available.

Plastic enclosures

1, 2 & 3 seat Modular range

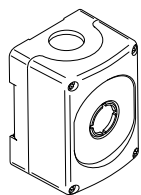

1 Position

1-seat Plastic enclosures. Yellow top/light grey bottom

Description					Catalog No.	List Price
	Pos - 1	Pos - 2	Pos - 3	Pos - 4		
Type	Twist Release 40mm E	—	—	—	P1-ES	\$ 84.00
	Stop	—	—	—		
Color	Red	—	—	—		
Contacts	2 NC	—	—	—		
Name plate	EMERGENCY STOP	—	—	—		
Type	III. Twist Release 40mm E	—	—	—	P1-1ES	107.50
	40mm E-Stop	—	—	—		
Color	Red, 120V	—	—	—		
Contacts	2 NC, 1 LB	—	—	—		
Name plate	EMERGENCY STOP	—	—	—		

1-seat Plastic enclosure, dark grey top/light grey bottom

Description					Catalog No.	List Price
	Pos - 1	Pos - 2	Pos - 3	Pos - 4		
Type	3-pos sel. Main	—	—	—	P1-HOA	\$ 55.00
Color	Black	—	—	—		
Contacts	2 NO	—	—	—		
Name plate	HAND/OFF/AUTO	—	—	—		

2-seat Plastic enclosure, dark grey top/light grey bottom

Description					Catalog No.	List Price
	Pos - 1	Pos - 2	Pos - 3	Pos - 4		
Type	Button mom, Ext.	Button mom, Flush	—	—	P2-SS	\$ 63.20
Color	Red	Green	—	—		
Contacts	1 NC	1 NO	—	—		
Name plate	STOP	START	—	—		
Type	3-pos sel. Main	Pilot Light	—	—	P2-1HOARL	90.00
Color	Black	Red	—	—		
Contacts	2 NO	1 LB	—	—		
Name plate	HAND/OFF/AUTO	RUN	—	—		
Type	2-pos sel. Main	Pilot Light	—	—	P2-1OORL	82.00
Color	Black	Red	—	—		
Contacts	1 NO	1 LB	—	—		
Name plate	ON/OFF	RUN	—	—		

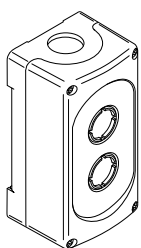

2 Position

1 Position

3-seat Plastic enclosure, dark grey top/light grey bottom

Description					Catalog No.	List Price
	Pos - 1	Pos - 2	Pos - 3	Pos - 4		
Type	Button mom, Ext.	Button mom, Flush	Pilot Light	—	P3-1SSRL	\$ 96.70
Color	Red	Green	Red	—		
Contacts	1 NC	1 NO	1 LB	—		
Name plate	STOP	START	RUN	—		
Type	3-pos sel. Main	Pilot Light	Pilot Light	—	P3-1HOARLGL	123.50
Color	Black	Red	Green	—		
Contacts	2 NO	1 LB	1 LB	—		
Name plate	HAND/OFF/AUTO	RUN	OFF	—		
Type	2-pos sel. Main	Pilot Light	Pilot Light	—	P3-1OORLGL	115.50
Color	Black	Red	Green	—		
Contacts	1 NO	1 LB	1 LB	—		
Name plate	ON/OFF	RUN	OFF	—		
Type	3-pos sel. Main	Button mom, Flush	Pilot Light	—	P3-1HOASRL	109.60
Color	Black	Green	Red	—		
Contacts	2 NO	1 NO	1 LB	—		
Name plate	HAND/OFF/AUTO	START	RUN	—		
Type	Twist Release 40mm E Stop	3-pos sel. Main	Pilot Light	—	P3-1ESHOARL	145.50
Color	Red	Black	Red	—		
Contacts	2 NC	2 NO	1 LB	—		
Name plate	EMERGENCY STOP	HAND/OFF/AUTO	RUN	—		

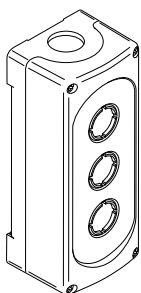

3 Position

2 Position

1 Position

Plastic enclosures

4 seat

Modular range



4-seat Plastic enclosure, dark grey top/light grey bottom

Description					Catalog No.	List Price
	Pos - 1	Pos - 2	Pos - 3	Pos - 4		
Type	Button mom., Ext.	Button mom., Flush	Pilot Light	Pilot Light	P4-1SSRLGL	\$ 134.20
Color	Red	Green	Green	Red		
Contacts	1 NC	1 NO	1 LB	1 LB		
Name plate	STOP	START	OFF	RUN		
Type	3-pos sel. Main	Button mom., Flush	Pilot Light	Pilot Light	P4-1HOASRLGL	147.10
Color	Black	Green	Green	RED		
Contacts	2 NO	1 NO	1 LB	1 LB		
Name plate	HAND/OFF/AUTO	START	OFF	RUN		
Type	3-pos sel. Main	Pilot Light	Pilot Light	Pilot Light	P4-1HOARLYLGL	161.00
Color	Black	Green	Yellow	Red		
Contacts	2 NO	1 LB	1 LB	1 LB		
Name plate	HAND/OFF/AUTO	OFF	FAULT	RUN		
Type	2-pos. sel. Main	Pilot Light	Pilot Light	Pilot Light	P4-10ORLYLGL	153.00
Color	Black	Green	Yellow	Red		
Contacts	1 NO	1 LB	1 LB	1 LB		
Name plate	ON/OFF	OFF	FAULT	RUN		
Type	Twist Release 40mm E Stop	Button mom., Ext.	Button mom., Flush	Pilot Light	P4-1ESSSRL	156.20
Color	Red	Red	Green	Red		
Contacts	2 NC	1 NC	1 NO	1 LB		
Name plate	EMERGENCY STOP	STOP	START	RUN		
Type	Twist Release 40mm E Stop	3-pos. sel. Main	Pilot Light	Pilot Light	P4-1ESHOARLGL	183.00
Color	Red	Black	Green	Red		
Contacts	2 NC	2 NO	1 LB	1 LB		
Name plate	EMERGENCY STOP	HAND/OFF/AUTO	OFF	RUN		
Type	Twist Release 40mm E Stop	2-pos sel. Main	Pilot Light	Pilot Light	P4-1ESOORLGL	175.00
Color	Red	Black	Green	Red		
Contacts	2 NC	1 NO	1 LB	1 LB		
Name plate	EMERGENCY STOP	ON/OFF	OFF	RUN		

Degree of protection, IP 66 Modular range

Empty plastic enclosures Now with stainless steel screws

Size	Color top/bottom	Catalog No.	Ref. Code	List Price
1-seat	Dark grey/Light grey	MEP1-0	1SFA 611 811 R1000	\$ 28.00
1-seat	Yellow/Light grey	MEPY1-0	1SFA 611 821 R1000	28.00
2-seat	Dark grey/Light grey	MEP2-0	1SFA 611 812 R1000	32.00
3-seat	Dark grey/Light grey	MEP3-0	1SFA 611 813 R1000	36.00
4-seat	Dark grey/Light grey	MEP4-0	1SFA 611 814 R1000	44.00
6-seat	Dark grey/Light grey	MEP6-0	1SFA 611 816 R1000	52.00

When Ordering

- Select operators from page 8.4 and 8.38.
N.B. Selector switches with short handle for vertically mounted selector switches must be Ref.ed from page 8.45 - 8.46
- Select contact blocks and lamp blocks for rear mounting, see page 8.45
- Accessories, see page 8.45
N.B. **One spacer per operator** has to be Ref.ed if legend plate is not used.
(for rear mounted pilot devices)

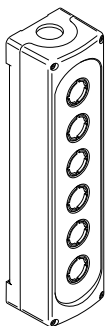
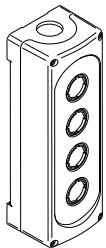
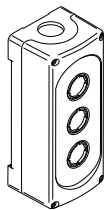
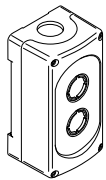
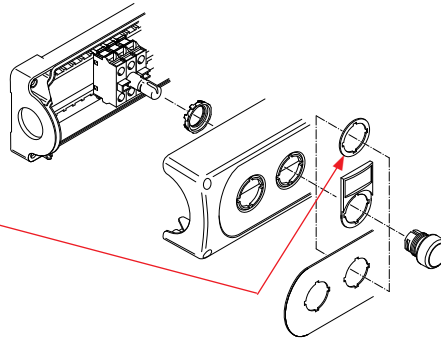

Accessories Modular range

Contact blocks for rear mounting

Description	Catalog No.	Ref. Code	List Price
Contact blocks			
1NO	MCB-10B	1SFA 611 610 R2001	\$ 8.00
1NC	MCB-01B	1SFA 611 610 R2010	

Double contact block

2NO	MCB-20B	1SFA 611 610 R2002	16.00
2NC	MCB-02B	1SFA 611 610 R2020	
1NO+1NC	MCB-11B	1SFA 611 610 R2011	

Contact blocks with gold plated contacts

1NO	MCB-10BG	1SFA 611 610 R2101	16.00
1NC	MCB-01BG	1SFA 611 610 R2110	

Lamp blocks

For max. 2 W, 230 V AC and DC filament bulb or LED

MLB-1B	1SFA 611 620 R2001	17.50
---------------	--------------------	--------------

115 V AC supply voltage.

For 60 V filament bulb max. 1.2 W

MLB-2B	1SFA 611 620 R2002	21.50
---------------	--------------------	--------------

230 V AC supply voltage.

For 130 V filament bulb max. 2 W

MLB-3B	1SFA 611 620 R2003	21.50
---------------	--------------------	--------------

Protective sleeve

Description	Catalog No.	Ref. Code	List Price
To make a rear mounted lamp block screen protected. IP20	53960543-1	5396 0543-1	\$ 2.00

Earthing terminal

Description	Catalog No.	Ref. Code	List Price
For plastic enclosure.	MA5-3005	1SFA 611 925 R3005	\$ 2.00

Shrouds

Color	Catalog No.	Reference Code
Yellow	MA1-8053	1SFA611920R8053
Gray	MA1-8128	1SFA611920R8128

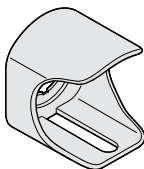
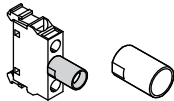
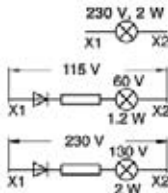
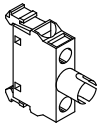
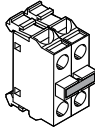
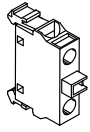

Yellow shroud

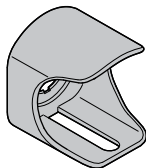

Gray shroud

Accessories Modular range

Spacer

Description	Catalog No.	Ref. Code	List Price
1 mm thick. Needed when legend plates are not used in plastic enclosures.			
Spacer (Packing unit 10 pieces)	SK615516-1	SK 615 516-1	\$ 1.00
Spacer for Modular emergency stop pushbutton (Packing unit 10 pieces)	KA1-8045	1SFA 616 920 R 8045	1.00

Blanking plug

Description	Catalog No.	Ref. Code	List Price
Grey plastic, 22mm	MA1-8129	1SFA 611 920 R8129	\$ 5.80
Black plastic, 22mm	MA1-8130	1SFA 611 920 R8130	5.80
Black plastic, 30mm	MA1-8133	1SFA 611 920 R8133	7.30

Cable gland

Description	Catalog No.	Ref. Code	List Price
PG 13.5	MA5-3006	1SFA 611 925 R3006	\$ 8.40
PG 16	MA5-3007	1SFA 611 925 R3007	9.40

Nut

Description	Catalog No.	Ref. Code	List Price
PG 13.5	MA5-3008	1SFA 611 925 R3007	\$ 2.60
PG 16	MA5-3009	1SFA 611 925 R3009	2.60

Adaptor

Description	Catalog No.	Ref. Code	List Price
PG 16/M20	MA5-3010	1SFA 611 925 R3010	\$ 16.20

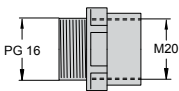
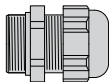
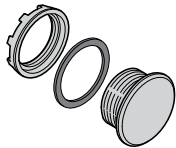

2 position selector switches for mounting in vertically mounted enclosures Modular range

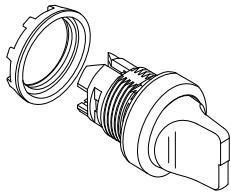
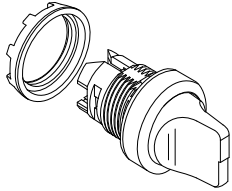

Bezel in black plastic as standard

Bezel in metal:

Replace '1' in the:

Catalog No. M2SSX-1 0X

Ref. Code 1SFA611XXX R 1XXX

3 for metal bezel

4 for grey plastic bezel

Contact functions

Block positions as seen from operator front.

Handle position	Left block	Right block
A (B)	O	O
O	x	x

O = not actuated (normal state)

x = actuated (state changed)

Non-illuminated operator ... ①

Symbol	Handle color	Catalog No.	Ref. Code	List Price
with short handle				
Maintained				
	Red	M2SSV1-10R	1SFA 611 220 R1001	\$ 11.00
	Black	M2SSV1-10B	1SFA 611 220 R1006	
Maintained				
	Red	M2SSV2-10R	1SFA 611 221 R1001	11.00
	Black	M2SSV2-10B	1SFA 611 221 R1006	
Momentary, spring return from C to B				
	Red	M2SSV3-10R	1SFA 611 222 R1001	14.00
	Black	M2SSV3-10B	1SFA 611 222 R1006	

Illuminated operator ... ① ②

Symbol	Handle color	Catalog No.	Ref. Code	List Price
with short handle				
Maintained				
	Red	M2SSV1-11R	1SFA 611 220 R1101	\$ 17.00
	Green	M2SSV1-11G	1SFA 611 220 R1102	
	Yellow	M2SSV1-11Y	1SFA 611 220 R1103	
Maintained				
	Red	M2SSV2-11R	1SFA 611 221 R1101	17.00
	Green	M2SSV2-11G	1SFA 611 221 R1102	
	Yellow	M2SSV2-11Y	1SFA 611 221 R1103	
Momentary, spring return from C to B				
	Red	M2SSV3-11R	1SFA 611 222 R1101	26.00
	Green	M2SSV3-11G	1SFA 611 222 R1102	
	Yellow	M2SSV3-11Y	1SFA 611 222 R1103	

① No contact in center position

② Lamp block for max 230 V AC/DC. Bulb not included. Other lamp block see Accessories

3 position selector switches for mounting in vertically mounted enclosures Modular range

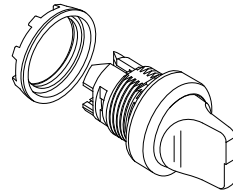
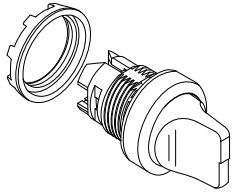

Bezel in black plastic as standard
Bezel in metal:
Replace '1' in the:
Catalog No. M3SSX-1 0X
Ref. Code 1SFA611XXX R 1XXX
3 for metal bezel
4 for grey plastic bezel

Contact functions

Block positions as seen from operator front.

Handle position	Left block	Right block
A	x	0
B	0	0
C	0	x

Non-illuminated operator ... ①

Symbol	Handle color	Catalog No.	Ref. Code	List Price
with short handle				
Maintained				
	Red	M3SSV1-10R	1SFA 611 230 R1001	\$ 11.00
	Black	M3SSV1-10B	1SFA 611 230 R1006	
Momentary, spring return from A to B and from C to B				
	Red	M3SSV2-10R	1SFA 611 231 R1001	14.00
	Black	M3SSV2-10B	1SFA 611 231 R1006	
Momentary, spring return from C to B				
	Red	M3SSV3-10R	1SFA 611 232 R1001	14.00
	Black	M3SSV3-10B	1SFA 611 232 R1006	

Illuminated operator ... ① ②

Symbol	Handle color	Catalog No.	Ref. Code	List Price
with short handle				
Maintained				
	Red	M3SSV1-11R	1SFA 611 230 R1101	\$ 17.00
	Green	M3SSV1-11G	1SFA 611 230 R1102	
	Yellow	M3SSV1-11Y	1SFA 611 230 R1103	
Momentary, spring return from A to B and from C to B				
	Red	M3SSV2-11R	1SFA 611 231 R1101	26.00
	Green	M3SSV2-11G	1SFA 611 231 R1102	
	Yellow	M3SSV2-11Y	1SFA 611 231 R1103	
Momentary, spring return from C to B				
	Red	M3SSV3-11R	1SFA 611 232 R1001	26.00
	Green	M3SSV3-11G	1SFA 611 232 R1002	
	Yellow	M3SSV3-11Y	1SFA 611 232 R1003	

Contact blocks, lamp block and holder See Page 8.45

① No contact in center position

② Lamp block for max 230 V AC/DC. Bulb not included. Other lamp block see Accessories

Compact E-Stop Component parts

1-seat emergency-stop enclosures

	Description	Catalog Number	Order Code	List Price
	Enclosure 1-Seat Dark grey/light grey 50D _{mm} x 65W _{mm} 65H _{mm}	CEP1-0	1SFA 619 811 R1000	\$ 22
	Enclosure 1-Seat Yellow/light grey 50D _{mm} x 65W _{mm} 65H _{mm}	CEPY1-0	1SFA 619 821 R1000	22
	Shroud For emergency stops; yellow 30D _{mm} x 45W _{mm} 60H _{mm}	CA1-8053	1SFA 619 920 R8053	10
	Shroud For machine stops; dark grey 30D _{mm} x 45W _{mm} 60H _{mm}	CA1-8054	1SFA 619 920 R8054	10
	Legend plate, yellow aluminum 60mm	CA6-1026	1SFA619930R1026	6

Compact E-Stop Assembled stations

Assembled 1-seat emergency stop enclosures

	Description	Catalog Number	Order Code	List Price
	Emergency Stop Enclosure Twist release; red button 2NC	CEPY1-1001	1SFA 619 821 R1001	\$ 73
	Emergency Stop Enclosure Pull release; red button 2NC	CEPY1-1002	1SFA 619 821 R1002	73
	Emergency Stop Enclosure with Shroud Twist release; red button 2NC	CEPY1-2001	1SFA 619 821 R2001	84
	Emergency Stop Enclosure with Shroud Pull release; red button 2NC	CEPY1-2002	1SFA 619 821 R2002	84
	Machine Stop Enclosure Twist release; black button 1NO + 1NC	CEP1-1001	1SFA 619 81 R1002	73
	Machine Stop Enclosure Pull release; black button 1NO + 1NC	CEP1-1002	1SFA 619 811 R1002	73
	Machine Stop Enclosure with Shroud Twist release; black button 1NO + 1NC	CEP1-2001	1SFA 619 811 R2001	84
	Machine Stop Enclosure with Shroud Pull release; black button 1NO + 1NC	CEP1-2002	1SFA 619 811 R2002	84