



Inductive 3 Wire DC Sensing range: 1.5mm

Operating distance		1.5mm	1.5mm
Catalog number		SIF1.5Z6NU2PO	SIF1.5Z6NC8PO
List price		\$ 80.00	\$ 82.00
Sensor mounting		Shielded	Shielded
Output			
Suffix PO		PNP Normally Open	PNP Normally Open
Suffix NO			
Operating voltage	VDC	10 – 60	10 – 60
Load current	mA	100	100
Switching frequency	Hz	500	500
No load supply current	mA	15	15
Voltage drop	VDC	2	2
Short circuit protection		yes	yes
Reverse polarity protection		yes	yes
Output indication		LED yellow	LED yellow
Operating temperature	°F	-13 ... +158	-13 ... +158
Protection IEC		IP67	IP67
Approvals			
CE		yes	yes
UL Listed		yes	yes
CSA		yes	yes
Wire size		26 AWG/0.14mm ²	—
Housing material		Stainless steel	Stainless steel
Housing diameter	mm	6.5	6.5
Sensing face		Crastin	Crastin
Connection		2 m, PUR cable	Connector M8



10

Approximate dimensions

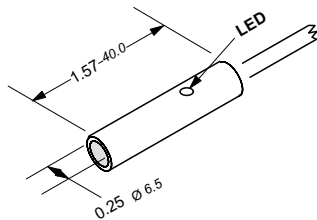

Wiring diagrams

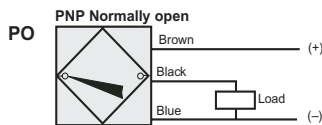

Approximate dimensions

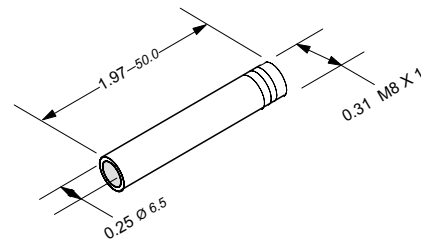

Wiring diagrams

