

Transformers

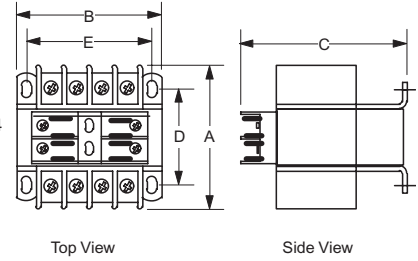

T4050PSF1

Primary voltage — 460/230/208V, 480/240V, 440/220/200V
Secondary voltage — 115/24V Ⓢ, 120/25V, 110/23V

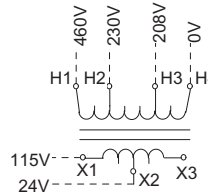
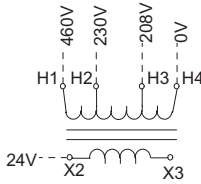
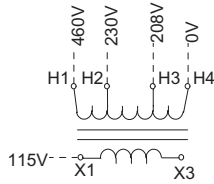

VA rating	Catalog number	List price	Output amps 24/115	Dimensions (inches • mm)					mounting slots	Approx. wt. Lbs • kg
				A	B	C	D	E		
45	T4045SF1	\$ 39.00	1.90 / 0.39	3 1/4 • 83	3 • 76	2 9/16 • 65	2 1/4 • 57	2 1/2 • 64	1 3/64 x 3/8 • 5 x 10	3.4 • 1.6
50	T4050PSF1	45.00	2.08 / 0.44	3 1/4 • 83	3 • 76	3 15/16 • 100	2 1/4 • 57	2 1/2 • 64	1 3/64 x 3/8 • 5 x 10	3.4 • 1.6
75	T4075PSF1	50.00	3.13 / 0.65	3 1/2 • 89	3 3/8 • 86	3 15/16 • 100	2 1/2 • 64	2 13/16 • 71	1 3/64 x 3/8 • 5 x 10	4.8 • 2.2
100	T4100PSF1	55.00	4.17 / 0.87	3 5/8 • 92	3 3/4 • 95	4 1/4 • 108	2 1/2 • 64	3 1/8 • 79	1 3/64 x 3/8 • 5 x 10	5.9 • 2.7
150	T4150PSF1	59.00	6.25 / 1.30	4 3/8 • 111	3 3/4 • 95	4 9/16 • 116	3 1/4 • 83	3 1/8 • 79	1 3/64 x 3/8 • 5 x 10	7.9 • 3.6
200	T4200PSF1	70.00	8.33 / 1.74	4 1/2 • 114	4 1/2 • 114	5 3/16 • 132	3 • 76	3 3/4 • 95	1 3/64 x 3/8 • 5 x 10	10.6 • 4.8
250	T4250PSF1	78.00	10.42 / 2.17	5 1/4 • 133	4 1/2 • 114	5 3/16 • 132	3 3/4 • 95	3 3/4 • 95	1 3/64 x 3/8 • 5 x 10	13.9 • 6.3
300	T4300PSF1	85.00	12.50 / 2.61	5 1/8 • 130	5 1/4 • 133	6 1/8 • 156	3 7/8 • 98	4 3/8 • 111	5/16 x 11/16 • 8 x 17	15.5 • 7.1
350	T4350PSF1	92.00	14.58 / 3.04	5 3/8 • 137	5 1/4 • 133	6 1/8 • 156	4 1/8 • 105	4 3/8 • 111	5/16 x 11/16 • 8 x 17	16.8 • 7.6
500	T4500PSF1	123.00	20.84 / 4.35	6 7/8 • 175	5 1/4 • 133	6 1/8 • 156	5 1/4 • 133	4 3/8 • 111	5/16 x 11/16 • 8 x 17	23.4 • 10.6

NOTE: Primary & secondary fuse block provided as standard (except for the 45VA unit where only the secondary fuse clip is provided).



T4750PS1

Primary voltage — 460/230/208V, 480/240V, 440/220/200V
Secondary voltage — 115V, 120V, 110V

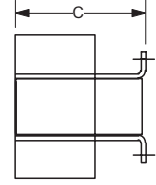
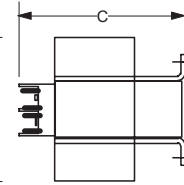
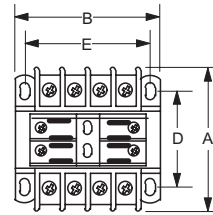
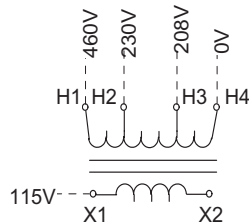

VA rating	Catalog number	List price	Output amps	Dimensions (inches • mm)					mounting slots	Approx. wt. Lbs • kg
				A	B	C	D	E		
750 Ⓢ	T4750PS1	\$ 145.00	6.52	7 3/8 • 187	5 1/4 • 133	6 1/8 • 156	5 3/4 • 146	4 3/8 • 111	5/16 x 11/16 • 8 x 17	30.0 • 13.6
1000	T41K1	160.00	8.70	7 1/8 • 181	6 3/8 • 162	5 3/8 • 137	4 1/2 • 114	5 5/16 • 135	5/16 x 11/16 • 8 x 17	29.2 • 13.3
1500	T41.5K1	230.00	13.04	7 1/2 • 191	6 3/4 • 171	5 11/16 • 144	4 7/16 • 113	6 1/16 • 154	9/32 x 9/16 • 7 x 14	33.5 • 15.2
2000	T42K1	280.00	17.39	8 1/4 • 210	6 3/4 • 171	5 11/16 • 144	5 1/4 • 133	6 1/16 • 154	9/32 x 9/16 • 7 x 14	42.5 • 19.3
3000	T43K1	395.00	26.09	8 9/16 • 217	9 • 229	7 1/2 • 191	5 3/4 • 147	7 1/2 • 191	7/16 x 3/4 • 11 x 19	77.0 • 35.0
5000	T45K1	660.00	43.48	10 1/2 • 267	9 • 229	10 3/16 • 259	6 1/2 • 165	6 1/2 • 165	7/16 x 3/4 • 11 x 19	102 • 46.4

Ⓢ Primary & secondary fuse block provided as standard (750VA unit, only).

Ⓢ Whenever both secondary voltages are to be used at the same time, remove the secondary fuse clip and use a separate mounted 2 pole fuse block.