

16A – 100A, Base & DIN rail mounted Accessories

Disconnect
switches
Non-fusible

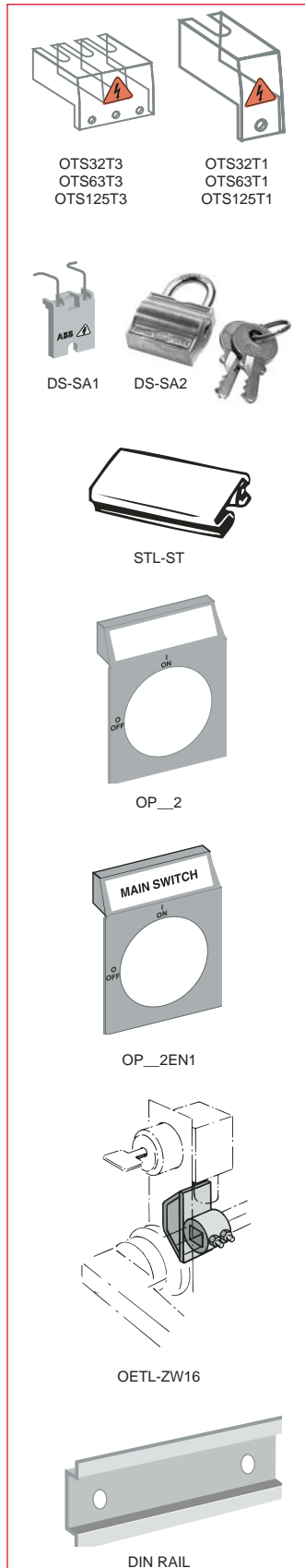

Terminal shrouds ① — snap on mounting for line or load side

Description	For use on:	Weight (lbs.)	Catalog number	List price
3 pole includes one shroud for line or load side	OT16, OT25, OT32	0.02	OTS32T3	\$ 8
	OT45, OT63	0.02	OTS63T3	12
	OT30, OT60, OT100	0.02	OTS125T3	20
4th pole includes one shroud for line or load side	OTP_32EP	0.02	OTS32T1	4
	OTP_63EP	0.02	OTS63T1	6
	OTP_125EP	0.02	OTS125T1	10

Padlocking adapter

Description	For use on:	Weight (lbs.)	Catalog number	List price
Adapter for one padlock with a max. 0.137" shackle	OT30, OT45 - OT100	0.02	DS-SA1	\$ 10
Padlock for DS-SA1		0.22	DS-SA2	28
Adapter and padlock	OT30, OT45 - OT100	0.24	DS-SA3	38

Labelling accessories

Description	For use on:	Package quantity	Catalog number	List price
1 Pkg. of label carriers 1 Pkg of blank description labels	OT30, OT45 – OT100	100 pieces	STL-ST	\$ 74
		315 pieces	ST-E	12

Legend plates for selector handles

Description	For use on:	Catalog number	List price
Blank plate	Black	OPB1	\$ 6
	Yellow	OPY1	6
	Black	OPB2	8
	Yellow	OPY2	8
Plate marked with: MAIN SWITCH	Black	OPB1EN1	10
	Yellow	OPY1EN1	10
	Black	OPB2EN1	12
	Yellow	OPY2EN1	12

Locking accessories

Description	For use on:	Weight (lbs.)	Catalog number	List price
Cam attachment for Kirk Key, Castell, Lowe & Fletcher and Ronis interlock. For adapting to the interlock system. The interlock is not included.	5, 6 & 8mm shafts	0.29	OETL-ZW16	\$ 190

DIN rail

Description	For use on:	Weight (lbs.)	Length inches/mm	Catalog number	List price
35mm DIN Rail	OT16 – OT100	2.96	39.4/1000	DIN RAIL	\$ 52

Shaft support

Description	For use on:	Weight (lbs.)	Catalog number	List price
Shaft support	OT16 – OT100	0.30	OETL-ZX58	\$ 14

The shaft support is used for disconnects installed in deep enclosures.

① All disconnects are IP20 touch safe as standard. Terminal shrouds provide an additional level of protection.