

1200A – 3150A Accessories

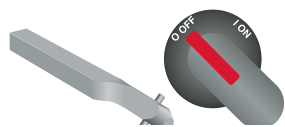

OESA-ZK_/45



OZXA-32



OZXA-28
OZXA-28/2

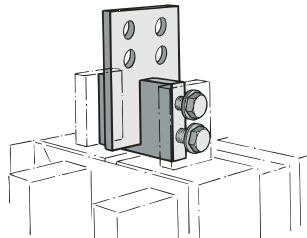

OETL-ZX115

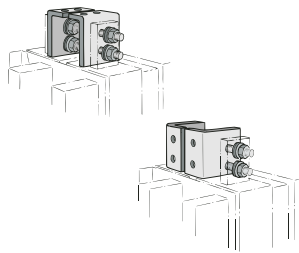

OETLZX114

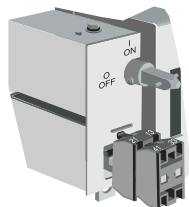

OZ XK-1
OZ XK-6



OZ XK-1

Twisted shafts – Rotates handle 45° □ .47 x .47" (□ 12 x 12 mm)

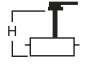
Shaft length inches/mm	 Mounting depth ① inches	Weight (lbs)	Catalog number	List price
11.0/280	11.6 – 15.3	0.77	EXP12X280-45	\$ 36
12.8/325	13.7 – 17.1	0.90	EXP12X325-45	40
18.3/465	18.9 – 22.6	1.32	EXP12X465-45	48

For use with OETL-NF1200

Shaft length inches/mm	Mounting depth ① inches	Weight (lbs)	Catalog number	List price
12.8/325	16.2 – 19.9	0.90	EXP12X325-45	40
18.3/465	18.9 – 22.6	1.32	EXP12X465-45	48

For use with OETL-NF1600 – OETL-NF3150

Terminal lug kits

For use on:	Wire size	Kit weight (lbs.)	Wire type	Terminal lugs per kit	Kit catalog number	List price
OETL-NF1200 & OETL-NF1600	(4) #2 – 600 kcmil	10.44	Cu/Al	6	OZXA-28	\$ 1000
OETL-NF1200 & OETL-NF1600	(4) #2 – 600 kcmil	5.22	Cu/Al	3	OZXA-28/3P	500
OETL-NF1200 & OETL-NF1600 ②	(8) 2/0 + (2) #2 600kcmil	10.44	Cu/Al	3	OZXA-32	600
OETL-NF2000 & OETL-NF3150	(8) #2 – 600kcmil	20.88	Cu/Al	12	OZXA-28/2	2000

OZXA-32 Power distribution lugs eliminate the need to purchase a separate distribution block

Busbar connections

Description	For use on:	Weight (lbs)	Catalog number	List price
Vertical ③, back or edgewise mounting	OETL-NF1600 – OETL-NF3150	46.2 31.0	OETL-ZX115 OETL-ZX114	\$ 3920 2820

Auxiliary contacts ④

Description	For use on:	Weight (lbs)	AC thermal amp rating	AC rated voltage	Catalog number	List price
1 N.O. + 1 N.C.	OETL-NF1200 – OETL-NF31500	0.20	10	600	OZ XK-1	\$ 100
2 N.O. + 2 N.C.		0.26	10	600	OZ XK-2	170
4 N.O. + 4 N.C.		0.40	10	600	OZ XK-3	340
2 N.O.		.18	10	600	OZ XK-4	100
4 N.O.		0.25	10	600	OZ XK-5	170
8 N.O.		0.40	10	600	OZ XK-6	340

Terminal shrouds

Description	For use on:	Weight (lbs)	Catalog number	List price
Includes one shroud for line or load side	OETL-NF1200	1.20	OETL-ZX119	\$ 220

① Mounting depth is the distance from the outside of the door to the disconnect switch mounting plate. Shaft can be cut to desired length.

② A load side distribution lug eliminates the need to purchase, install and wire a separate distribution block.

③ Provided as standard with OETL-NF1600, OETL-NF2000 and OETL-NF3150.