

## Approximate dimensions Enclosed

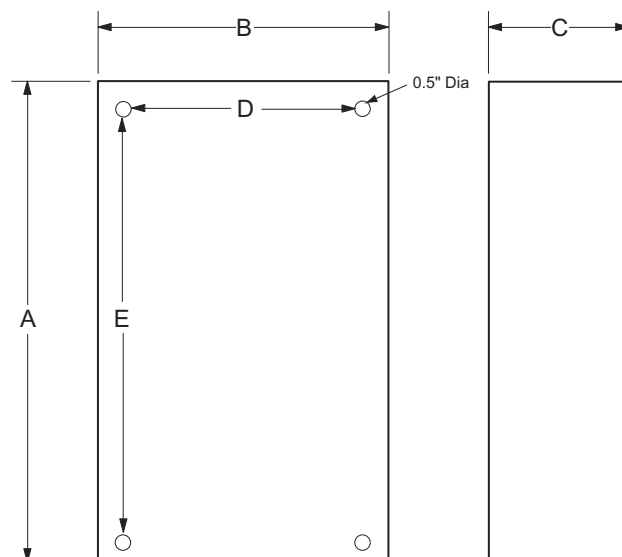

6

### 208V – 500V

Softstarter type	Softstarter combination	Dimensions In-line (in.)					Dimensions Inside delta (in.)				
		A	B	C	D	E	A	B	C	D	E
PSS18/30-500 thru PSS44/76-500	Softstarter only	20	20	12	18.50	18.50	20	20	12	18.50	18.50
	Softstarter with bypass	20	20	12	18.50	18.50	20	20	12	18.50	18.50
	Softstarter with fused disconnect ①	20	20	12	22.50	18.50	24	20	12	22.50	18.50
	Softstarter with circuit breaker ①	20	20	12	18.50	18.50	20	20	12	18.50	18.50
PSS50/85-500 thru PSS72/124-500	Softstarter only	20	20	12	18.50	18.50	20	20	12	18.50	18.50
	Softstarter with bypass	20	20	12	18.50	18.50	20	20	12	18.50	18.50
	Softstarter with fused disconnect ①	24	20	12	22.50	18.50	24	20	12	22.50	18.50
	Softstarter with circuit breaker ①	20	20	12	18.50	18.50	20	20	12	18.50	18.50
PSS85/147-500 thru PSS142/245-500	Softstarter only	24	24	16	22.50	22.50	24	24	16	22.50	22.50
	Softstarter with bypass	24	24	16	22.50	22.50	24	24	16	22.50	22.50
	Softstarter with fused disconnect ①	36	30	16	34.50	28.50	36	30	16	34.50	28.50
	Softstarter with circuit breaker ①	30	24	20	28.50	22.50	30	24	20	28.50	22.50
PSS175/300-500 thru PSS300/515-500	Softstarter only	60	36	12	58.50	34.50	60	36	12	58.50	34.50
	Softstarter with bypass	60	36	12	58.50	34.50	60	36	12	58.50	34.50
	Softstarter with fused disconnect ①	87	36	24	—	—	87	36	24	—	—
	Softstarter with circuit breaker ①	87	36	24	—	—	87	36	24	—	—

### 575V – 690V

PSS18/30-690 thru PSS72/124-690	Softstarter only	20	20	12	18.50	18.50	20	20	12	18.50	18.50
	Softstarter with bypass	20	20	12	18.50	18.50	20	20	12	18.50	18.50
	Softstarter with fused disconnect ①	24	20	12	22.50	18.50	24	20	12	22.50	18.50
	Softstarter with circuit breaker ①	20	20	12	18.50	18.50	20	20	12	18.50	18.50
PSS85/147-690 thru PSS142/245-690	Softstarter only	24	24	16	22.50	22.50	24	24	16	22.50	22.50
	Softstarter with bypass	24	24	16	22.50	22.50	24	24	16	22.50	22.50
	Softstarter with fused disconnect ①	36	30	16	34.50	28.50	36	30	16	34.50	28.50
	Softstarter with circuit breaker ①	30	24	20	28.50	22.50	30	24	20	28.50	22.50
PSS175/300-690 thru PSS300/575-690	Softstarter only	60	36	12	58.50	34.50	60	36	12	58.50	34.50
	Softstarter with bypass	60	36	12	58.50	34.50	60	36	12	58.50	34.50
	Softstarter with fused disconnect ①	87	36	24	—	—	87	36	24	—	—
	Softstarter with circuit breaker ①	87	36	24	—	—	87	36	24	—	—

① Dimensions remain the same if bypass contactor is added.