

Components Pushbutton and pilot light lens inserts^①

Legend	Cap color	Suffix code ^②	Flush button catalog number	Extended button catalog number	Pilot light catalog number	List price
	White	C82	CBK-KC82	—	—	\$.90
Start	White	C67	CBK-KC67	CBK-KC67E	CBK-KC67P	
START	Green Black	C5 C81	CBK-KC5 CBK-KC81	— —	— —	
On	White	C68	CBK-KC68	CBK-KC68E	CBK-KC68P	
ON	White Green Black	C69 C70 C1	CBK-KC69 CBK-KC70 CBK-KC1	— — —	CBK-KC69P — —	
Off	White	C71	CBK-KC71	CBK-KC71E	CBK-KC71P	
OFF	White Red Black	C72 C73 C2	— — CBK-KC2	CBK-KC72E CBK-KC73E CBK-KC2E	— — —	
Stop	White	C74	CBK-KC74	CBK-KC74E	CBK-KC74P	
STOP	Red	C4	CBK-KC4	CBK-KC4E	—	
Reset	White	C75	CBK-KC75	CBK-KC75E	CBK-KC75P	
Blank	White Green	C15 CG	CBK-KC15 CBK-KCG	CBK-KC15E CBK-KCEG	CBK-KC15P —	
UP	Green	C11	CBK-KC11	—	—	
DOWN	Green	C12	CBK-KC12	—	—	
OPEN	White Green	C16 C19	CBK-KC16 CBK-KC19	— —	— —	
CLOSE	White Green	C17 C20	CBK-KC17 CBK-KC20	— —	— —	
REV	Green	C6	CBK-KC6	—	—	
FWD	Green	C7	CBK-KC7	—	—	
SLOW	Green	C8	CBK-KC8	—	—	
FAST	Green	C9	CBK-KC9	—	—	
JOG	Green	C10	CBK-KC10	—	—	
RESET	Black	C3	CBK-KC3	—	—	
LATCH	White	C18	CBK-KC18	—	—	

8

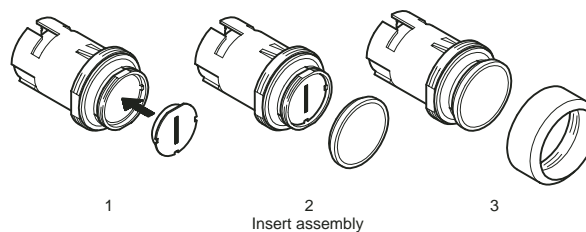
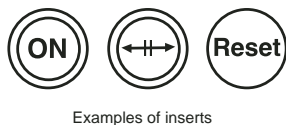
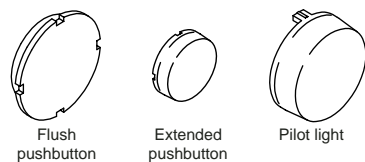

^① Illuminated pushbuttons and pilot lights must use white insert.

^② For extended pushbuttons, insert "E" at the end of the catalog number. For pilot lights, insert "P" at end of the catalog number.