

Compact Range

New range of Pilot Devices, 22 mm



Pilot Devices, Compact Range

The competitive choice

The compact range is a new competitive choice for OEM customers and Panel Builders with high requirements of cost efficient, easy to use and reliable products.

Features

- Reliable performance
- Less stock-keeping
- “All-in-one function” One Order Code = one complete function
- Robust design
- Easy mounting

Part of the ABB Family

The compact range can easily be combined with our modular Pilot Devices as they have the same front design.

Worldwide availability

ABB is represented in over 130 countries. Our pilot devices meet all major international and national standards.

Technical advantages

- High degree of protection
- One or two built-in electrically separated contacts (1NO, 1NC, 2NO, 2NC or 1NC + 1NO)
- Contacts with wiping action
- Low built-in depth



Same front design for both the modular and the compact range. Robust actuators in clear colors with large text and push area.



Samples of accessories



Pushbuttons, non-illuminated



Contacts included		Pushbutton		Pushbutton		Pushbutton		Pushbutton	
NO	NC	Momentary Flush button	Maintained Flush button	Momentary Extended button	Maintained Extended button	Catalog No.	List Price	Catalog No.	List Price
1	-	CP110■-10	\$ 15.20	CP210■-10	Price & availability to be announced	CP310■-10	\$ 15.20	CP410■-10	Price & availability to be announced
2	-	CP110■-20	19.90	CP210■-20		CP310■-20	19.90	CP410■-20	
-	1	CP110■-01	15.20	CP210■-01		CP310■-01	15.20	CP410■-01	
-	2	CP110■-02	19.90	CP210■-02		CP310■-02	19.90	CP410■-02	
1	1	CP110■-11	19.90	CP210■-11		CP310■-11	19.90	CP410■-11	

NOTE: For custom inserts consult factory.

Color	Code letter
Red ●	R
Green ●	G
Yellow ●	Y
Blue ●	L
White ○	W
Black ●	B
Grey ●	U

Ordering example

Requested: A compact pushbutton, momentary, with red extended button and one NO contact.

Order: 1 piece of CP310R-10



Pushbuttons, non-illuminated



Contacts included		Pushbutton		Pushbutton	
NO	NC	Momentary Flush button, white with black I	Maintained Flush button, black with black II	Momentary Extended button, black with white O	
1	-	CP1110W-10	\$ 16.70	CP1210W-10	\$ 16.70
-	1	-	-	CP3310B-01	Price & availability to be announced

Discount Schedule CA

Selector switches, non-illuminated



Two position

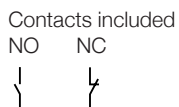

Maintained



Maintained



Momentary



		Catalog No.	List Price	Catalog No.	List Price	Catalog No.	List Price
1	-	C2SS110-10	\$ 19.60	C2SS210-10	\$ 19.60	C2SS310-10	\$ 22.70
2	-	C2SS110-20	27.20	C2SS210-20	27.20	C2SS310-20	27.20
-	1	C2SS110-01	22.70	C2SS210-01	22.70	C2SS310-01	22.70
-	2	C2SS110-02	27.20	C2SS210-02	27.20	C2SS310-02	27.20
1	1	C2SS110-11	27.20	C2SS210-11	27.20	C2SS310-11	27.20

Color		Code letter
Red		R
Black		B
Grey		U

Three position

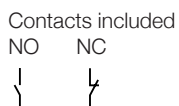

Maintained



Momentary



Momentary



Momentary



		Catalog No.	List Price	Catalog No.	List Price	Catalog No.	List Price	Catalog No.	List Price
2	-	C3SS110-20	\$ 27.20	C3SS210-20	\$ 27.20	C3SS310-20	\$ 27.20	C3SS710-20	\$ 27.20
-	2	C3SS110-02	27.20	C3SS210-02	27.20	C3SS310-02	27.20	C3SS710-02	27.20
1	1	C3SS110-11	27.20	C3SS210-11	27.20	C3SS310-11	27.20	C3SS710-11	27.20

Ordering example

Requested: A red compact selector switch with three positions, Momentary, spring return from A to B and maintained position in C. With 2 NC contacts.

Order: 1 piece of C3SS710R-02



Pilot Lights



Pilot light BA 9s base

Color		Catalog No.	List Price
Red		CL-100R	\$ 14.00
Green		CL-100G	14.00
Yellow		CL-100Y	14.00
Blue		CL-100L	14.00
White		CL-100W	14.00
Clear		CL-100C	14.00



Accessories

Description				Catalog No.	List Price
Filament bulbs BA 9s base					
Type of current: AC/DC.					
Rated voltage, V	Rated current, mA	Rated output, W	Service life, h		
6	200	1.2	10 000	CBK-LB6	\$ 6.00
12	100	1.2	10 000	CBK-LB12	6.00
24	50	1.2	10 000	CBK-LB24	6.00
30	40	1.2	10 000	CBK-LB30	6.00
48	42	2	6 000	CBK-LB48	6.00
60	20	1.2	5 000	CBK-LB60	6.00
110	18	2	7 500	CBK-LB110	6.00
130	15	2	7 500	CBK-LB1	6.00

LEDs

With one diode chip mounted on a BA 9s base.

Choose the same color for the LED and the lamp cap or else use a clear lamp cap.

For white light use white LED with clear lamp cap.

At DC the lamp base have to be connected to cathode (-) and the bottom contact to anode (+).

Rated voltage, V	Rated current, mA	Color	Wave-length, nM	Luminance, mcd	Catalog No.	List Price
Type of current: DC Service life >50 000 hours						
12	15	Red	630	250	CBK-LBD12R	\$ 27.00
12	15	Green	525	800	CBK-LBD12G	27.00
12	15	Yellow	592	250	CBK-LBD12Y	27.00
12	15	Blue	470	400	CBK-LBD12L	32.00
12	15	White	x=0.31 y=3.2	500	CBK-LBD12W	32.00
Type of current: (AC)/DC¹⁾ Service life >50 000 hours						
24	15	Red	630	250	CBK-LBD8R	15.00
24	15	Green	525	800	CBK-LBD8G	15.00
24	15	Yellow	592	250	CBK-LBD8Y	15.00
24	15	Blue	470	400	CBK-LBD8L	18.00
24	15	White	x=0.31 y=3.2	500	CBK-LBD8W	18.00
Type of current: AC¹⁾ Service life 25 000 hours						
110-130	4-6	Red	630	25-35	CBK-LBD1R	15.00
110-130	4-6	Green	525	300-350	CBK-LBD1G	15.00
110-130	4-6	Yellow	592	60-90	CBK-LBD1Y	15.00
110-130	4-6	Blue	470	130-150	CBK-LBD1L	18.00
110-130	4-6	White	x=0.31 y=3.2	160-200	CBK-LBD1W	18.00
Type of current: AC/DC¹⁾ Service life 25 000 hours						
110-130	4-6	Red	630	25-35	CBK-LBD13R	21.00
110-130	4-6	Green	525	300-350	CBK-LBD13G	21.00
110-130	4-6	Yellow	592	60-90	CBK-LBD13Y	21.00
110-130	4-6	Blue	470	130-150	CBK-LBD13L	28.00
110-130	4-6	White	x=0.31 y=3.2	160-200	CBK-LBD13W	28.00
Type of current: AC¹⁾ Service life 25 000 hours						
230	4	Red	630	25	CBK-LBD2R	21.00
230	4	Green	525	300	CBK-LBD2G	21.00
230	4	Yellow	592	60	CBK-LBD2Y	21.00
230	4	Blue	470	130	CBK-LBD2L	24.00
230	4	White	x=0.31 y=3.2	160	CBK-LBD2W	24.00

¹⁾ At AC the luminance is decreased with 30 % and there is also a slight flickering.

Discount Schedule CA

Accessories

Description	Catalog No.	List Price		
<h2>Protective membrane</h2> <p>Of transparent, heat and cold resistant rubber. Does not harden at low temperature. Gives IP 67 degrees of protection. When membrane is used, remove the gasket. For operator with:</p>				
Flush button	CBK-KXB	\$ 8.00		
Extended button	CBD-KXBE	8.00		
<h2>Mounting tool</h2> <p>Used for tightening the nut of the attachment device.</p>				
	CBK-KXHT	10.00		
<h2>30 mm adaptors</h2> <p>For use when fitting the 22 mm pilot devices in 30 mm mounting holes. (1.5 – 4 mm panels)</p>				
<p>For use with 22 mm Compact Pilot Light</p>				
Black plastic	CBK-PK3A	8.00		
Metal	CBK-PM3A	10.00		
<h2>Lamp changing tool</h2> <p>Designed for two different lamp diameters. The larger diameter fits filament bulbs and LEDs and the smaller diameter fits neon bulbs.</p>				
	KA1-8072	10.00		
<h2>Legend plates</h2> <p>Engraved fixed plates with symbol/text</p>				
Symbol/text	Legend plate material			
<p>For pushbutton</p>				
O	Silver-grey aluminium	CBK-NPE40 1.50		
Off	Silver-grey aluminium	CBK-NPE10 1.50		
On	Silver-grey aluminium	CBK-NPE11 1.50		
Start	Silver-grey aluminium	CBK-NPE19 1.50		
Stop	Silver-grey aluminium	CBK-NPE20 1.50		
Symbol/text	Legend plate material			
Centre	Right			
<p>For two-position selector switch</p>				
O	I	Silver-grey aluminium	CBK-NPE41 1.50	
Hand	Auto	Silver-grey aluminium	CBK-NPE22 1.50	
Off	On	Silver-grey aluminium	CBK-NPE24 1.50	
Stop	Start	Silver-grey aluminium	CBK-NPE25 1.50	
Symbol/text	Legend plate material			
Left	Centre	Right		
<p>For three-position selector switch</p>				
I	O	II	Silver-grey aluminium	CBK-NPE42 1.50
Hand	O	Auto	Silver-grey aluminium	CBK-NPE26 1.50
Slow	Off	Fast	Silver-grey aluminium	CBK-NPE27 1.50
<p>NOTE: For custom legend plates consult factory.</p>				

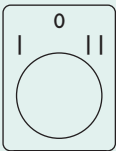
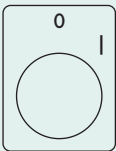
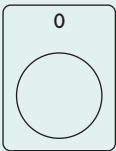
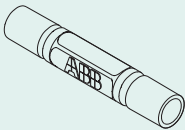
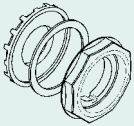
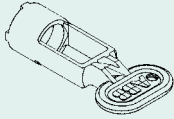

29.6 x 39 mm
Text height 3 mm

Discount Schedule CA

Technical data

Standards

IEC 73, 529, 947-5-1, 947-5-5
 EN 50 013, 60 947-5-1
 UL 508
 CSA C22.2 No. 14

Degree of protection

Operators

Compact pushbutton
 Compact pilot lights
 Compact selector switch

ICC UL/CSA

IP 66 1, 12, 3R, 4, 4X
 IP 66 1, 12, 3R, 4, 4X
 IP 66 1, 12, 3R, 4, 4X

Electrical functions

Terminals

IP 20

Mechanical life

Pushbuttons
 Selector switches

0.5 million operations
 0.5 million operations

Temperature

Ambient temperature during operation
 Storage temperature

-25 to +70 °C
 -30 to +85 °C

Terminals

Plus-minus Pozidrive Size 2
 Connectable area

min. 1 x 0.5 mm²
 max. 2 x 1.5 mm²/
 2 x AWG14

Contacts

Ratings as per UL/CSA, NEMA C300

Rated insulation voltage 250 VAC
 Rated thermal current 2.5 A

Rated operational current at 120 VAC
 240 VAC

Max. VA

Make	Break
15 A	1.5 A
7.5 A	0.75 A
1800 VA	180 VA

Ratings as per UL/CSA, NEMA R300

Rated insulation voltage 250 VDC
 Rated thermal current 1.0 A

Rated operational current at 125 VDC
 240 VDC

Max. make or break VA at 300V or less

Make	Break
0.22 A	0.22 A
0.11 A	0.11 A
28 VA	28 V A

Short circuit protection

Max. fuse at 1 kA

16 A ordinary
 10 A delayed

Bulbs max rating

3 W, 240 V

Drilling plan

for pushbuttons, switches and pilot lights

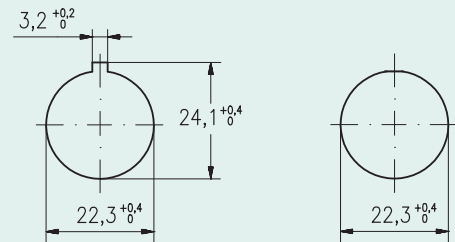

Dimensions

Compact Pushbutton

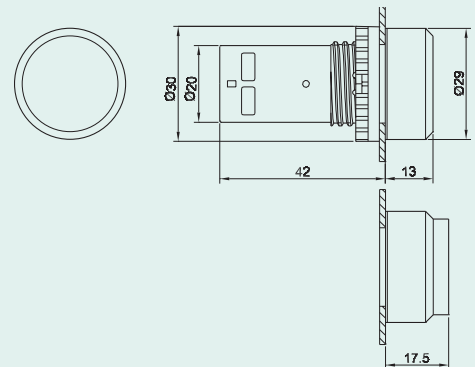

Compact Selector Switch

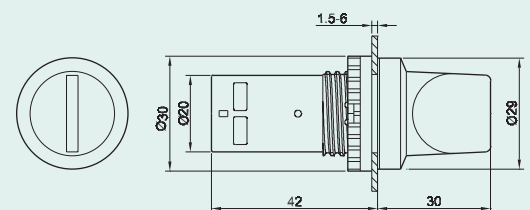

Compact Pilot Light

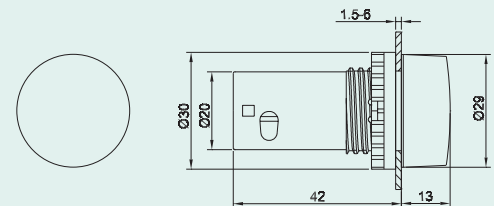

Get in touch with the Pilot Devices from ABB

*A pushbutton has to be sturdy and reliable,
applicable in all environments and adaptable to
widely differing requirements. Further, it should be
easy to install.*

*You will find all these features in ABB's range of
Pilot Devices.*



ABB Inc.
Low Voltage Products & Systems
1206 Hatton Rd.
Wichita Falls, TX 76302
Tel: (888) 385-1221
(940) 397-7000
Fax: (940) 397-7085

www.abb-control.com